

The Serviceberry B

Full Basement
2060 sqft

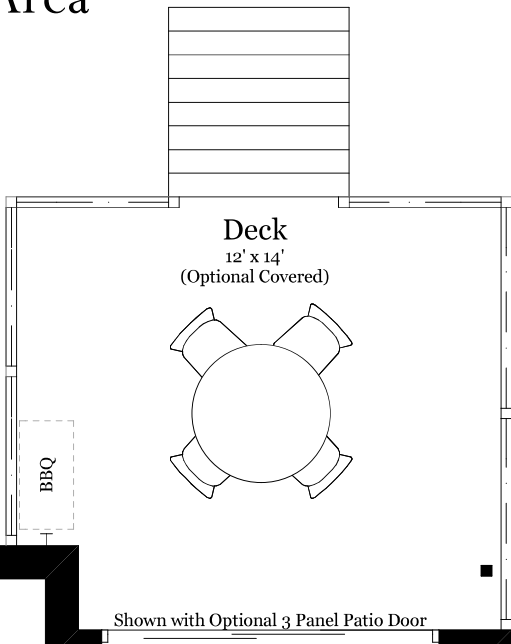

Optional Finished Basement Area
1140 sqft



Optional Screened in Porch
16'6" x 14'6"

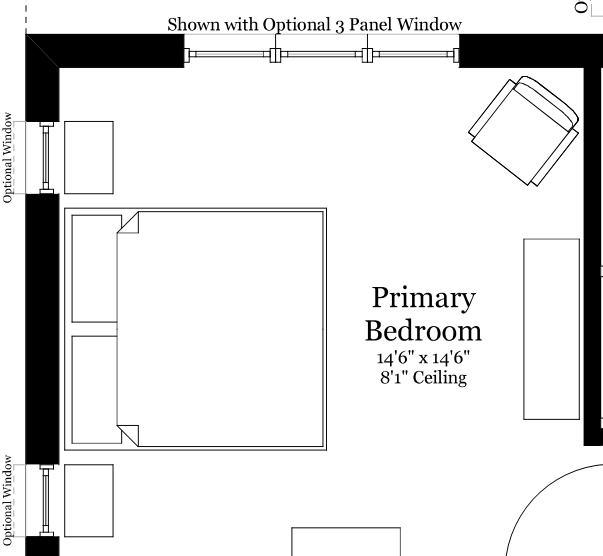

Great Room
17' x 19'6"

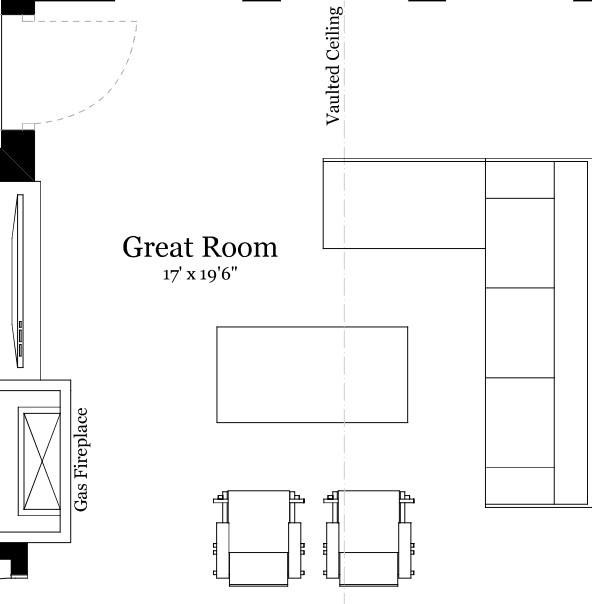

Dining Room
12' x 14'6"

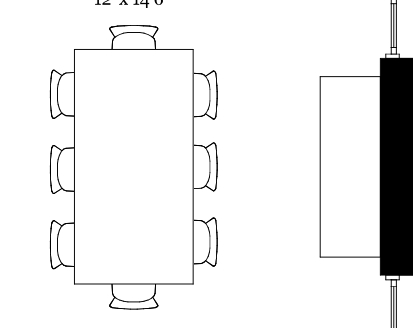

Ensuite
9'6" x 10'6"

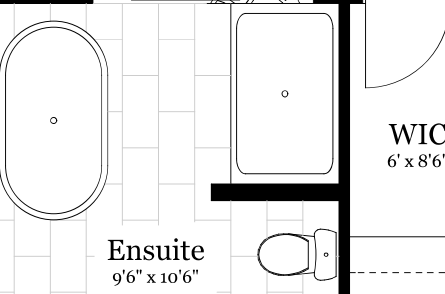

WIC
6' x 8'6"

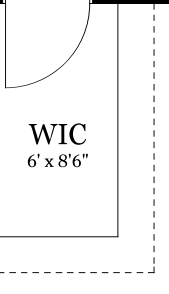

Open to Below

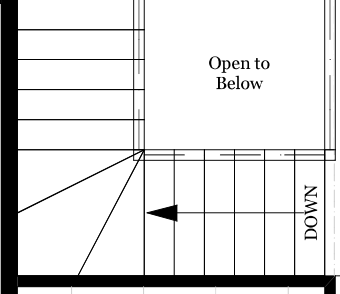

Kitchen
16' x 16'

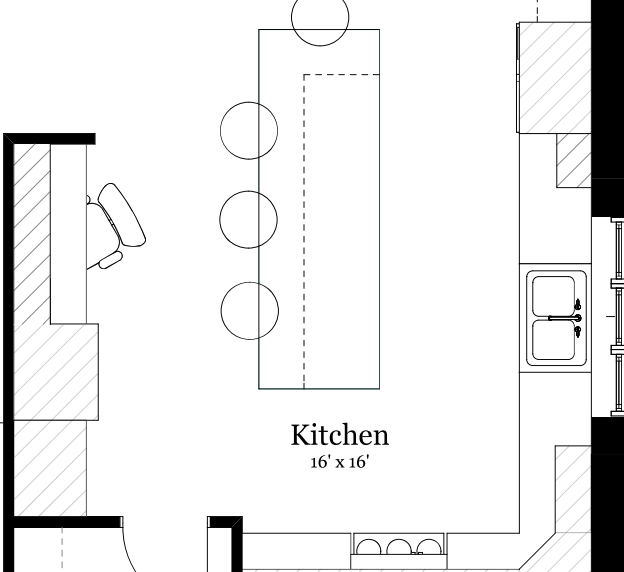

Storage
7' x 4'6"

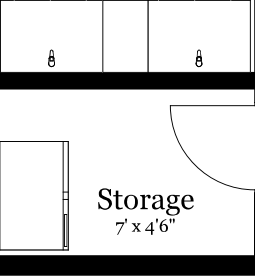

Laundry Room
8' x 7'
Shown with Optional Cabinets

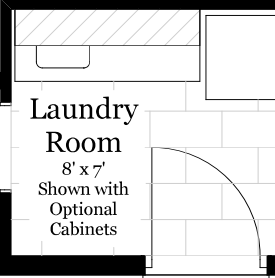

Mudroom
9' x 5'

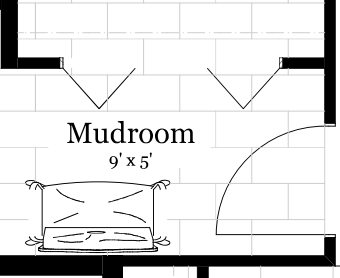

WIP
6' x 5'

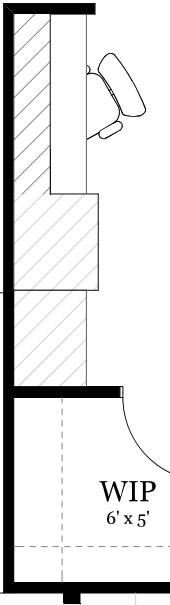

Main Bathroom
9'6" x 6'
8'1" Ceiling



Garage
20' x 20'

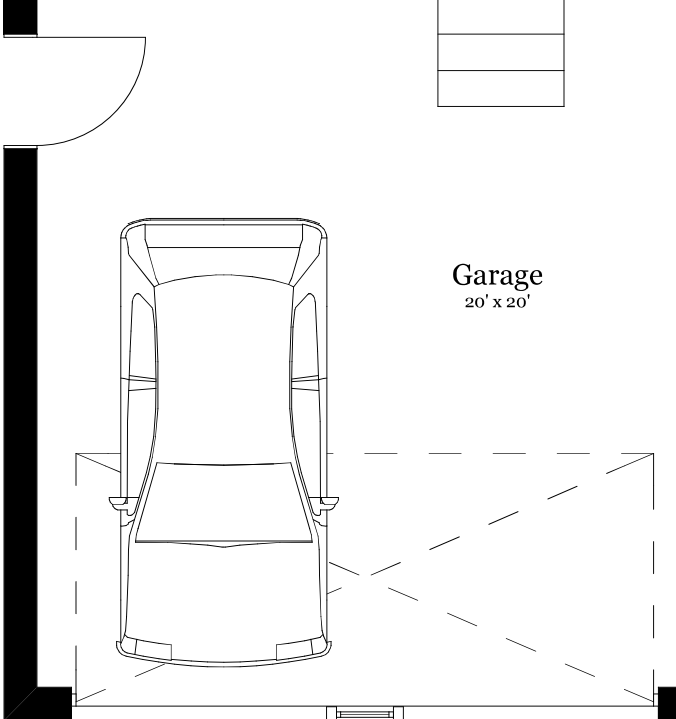

Foyer
9'6" x 8'6"

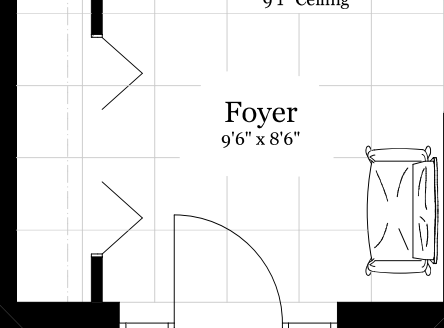

Covered Entry
11' x 7'
9'1" Ceiling

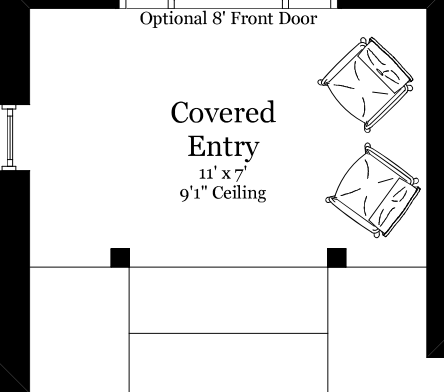

Den
14' x 12'

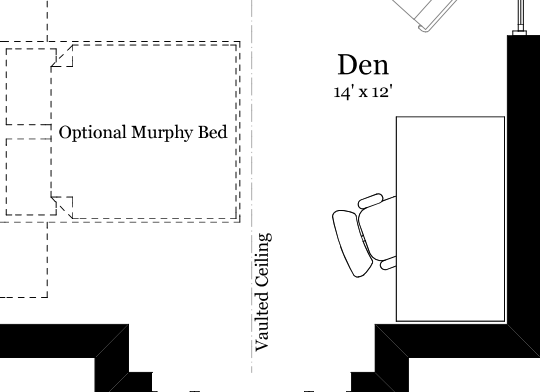

Main Floor Plan